

Impact sound insulation - outdoor

REGUPOL sound and drain 22

tiles with aluminium substructure on pedestals

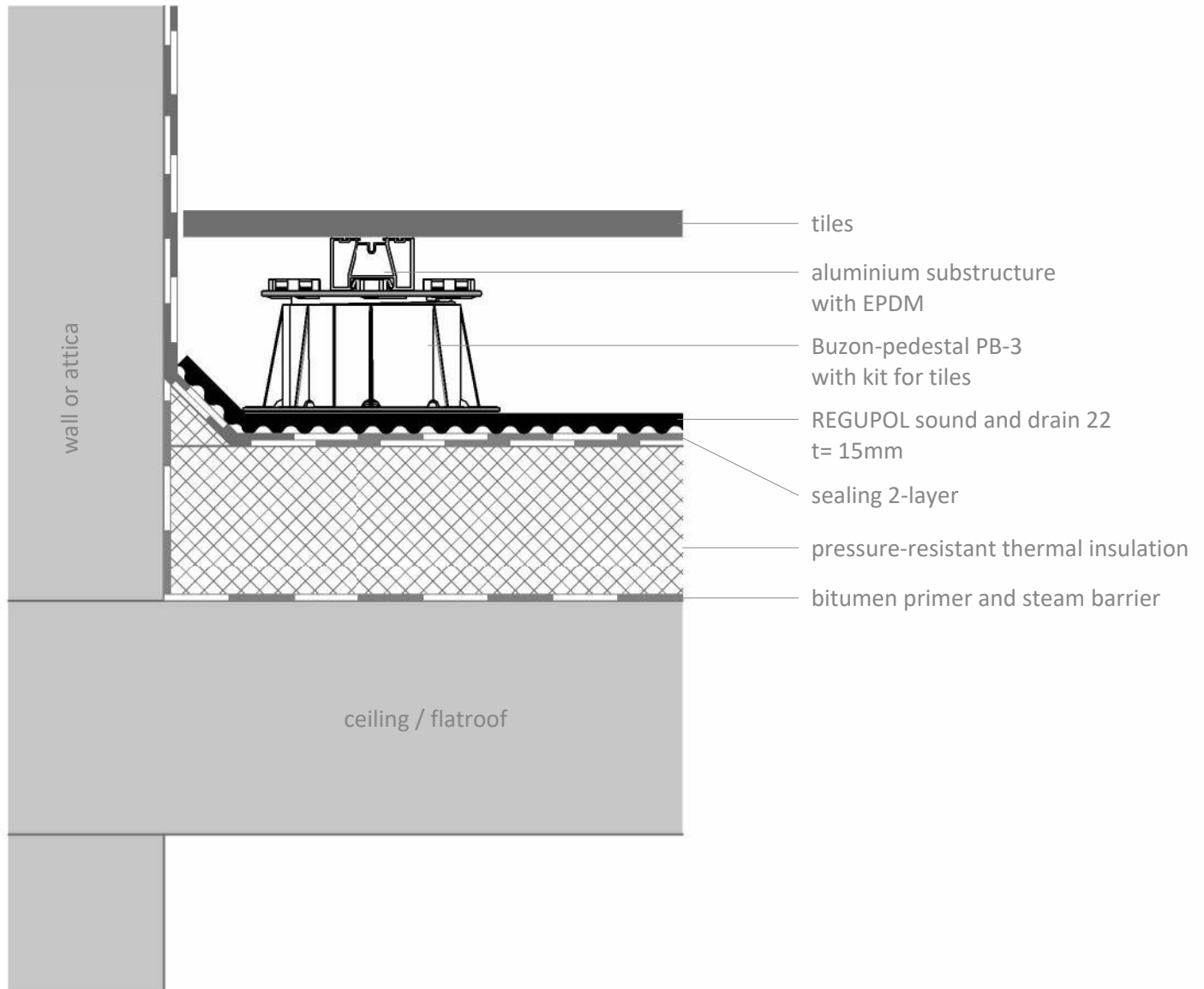

Contact

REGUPOL Germany GmbH & Co. KG
Am Hilgenacker 24
57319 Bad Berleburg
GERMANY
www.regupol.com

Notes

Adjacent trades are only shown schematically and in parts. The applicability and other conditions or constraints need to be checked by the customer or user on their own responsibility. The technical data sheets, installation instructions and local conditions need to be considered.

Project: ---

Project-No.: ---

Detail: VSCHW-01-08-B-EN

Created by: REGUPOL Acoustics

Date: 30.11.2023

Scale: 1 : 5